

CP9000

CP9000-AS

CP9000-WS

C9000-AS-WS

CP9000[SR]

CP9000-AS [SR]

CP9000-WS [SR]

C9000-AS-WS [SR]

CLASSEQ

Passthrough Warewasher

Quick Install Guide

EN

1 PACKING LIST

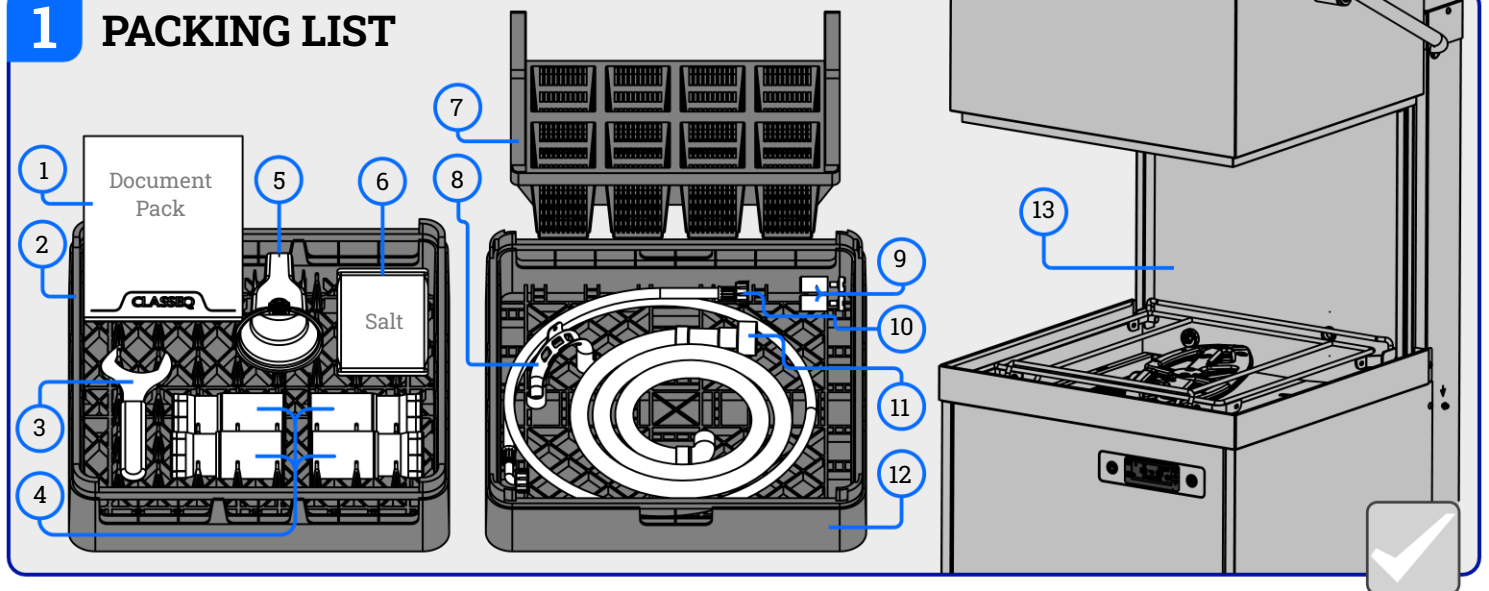

2 ATTACHING FEET

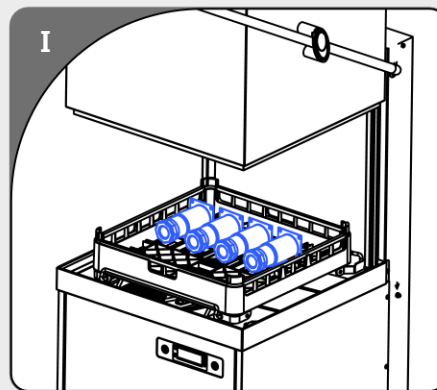
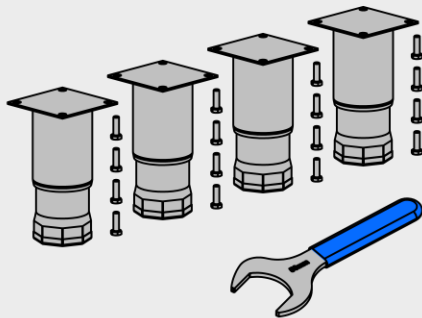

LOCATE

x4 feet (4) / x16 bolts (4) / 58mm spanner (3)

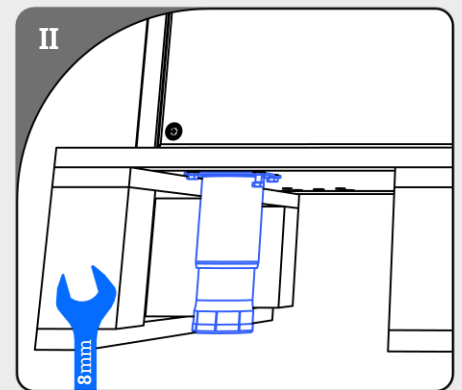

FIT

Feet (4) to base using an 8mm spanner (3)

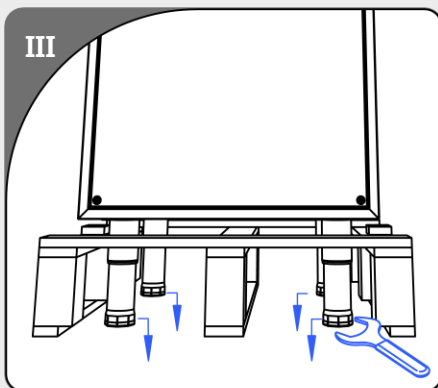

ADJUST

Adjust the feet until the machine is lifted from the pallet

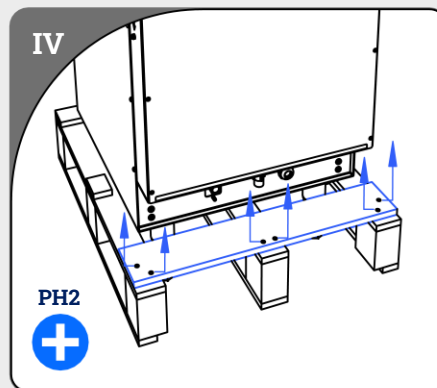

REMOVE

Unscrew the rear board from the pallet using the PH2 screwdriver and remove.

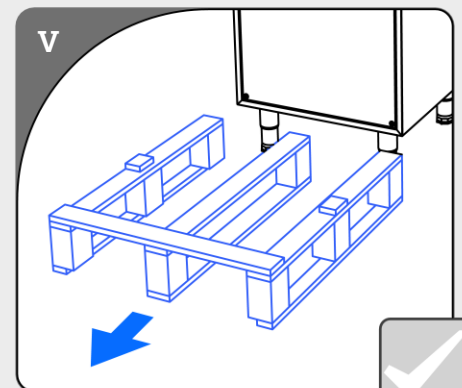

SLIDE

Slide the pallet out from under the machine from the front.

3 UTILITY CONNECTIONS



1

CHEMICAL CONNECTION

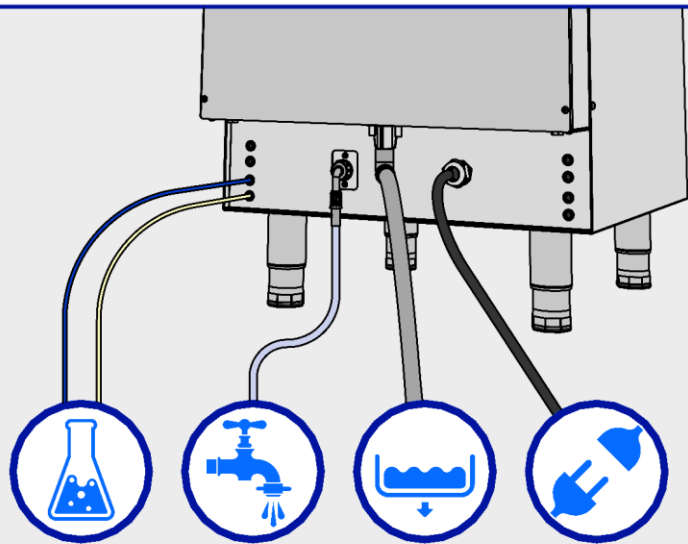
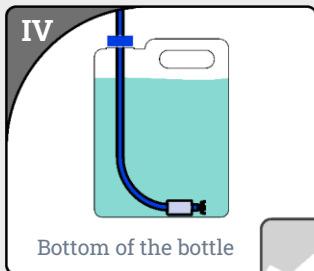
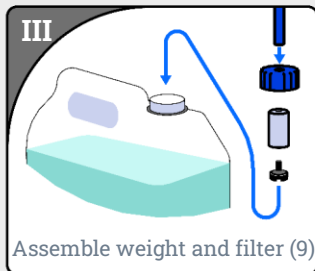
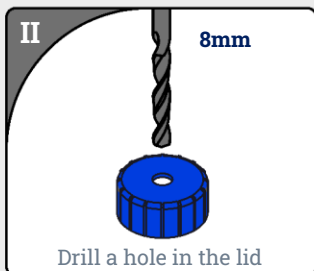
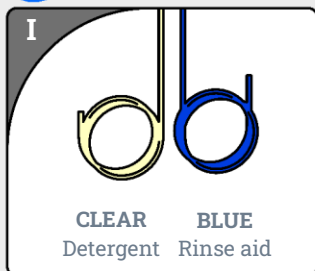

WARNING

ELECTRICAL CONNECTION

All mains electrical work must be carried out by a qualified electrician in line with local and national regulations.



2

FRESH WATER CONNECTION

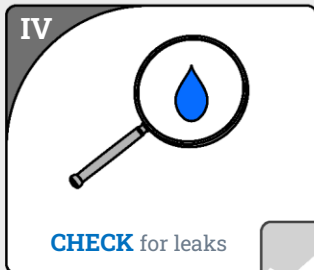
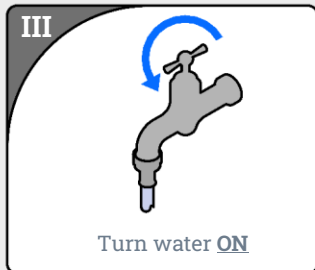
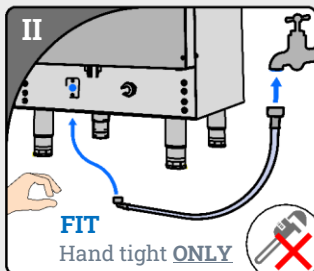
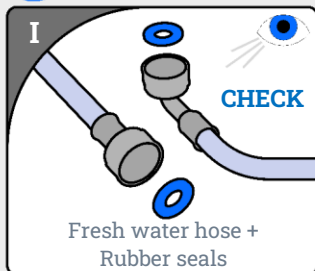

3

DRAIN CONNECTION

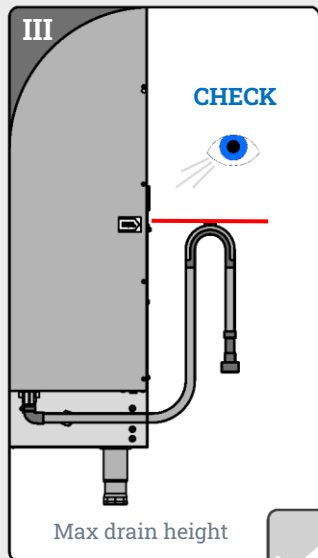
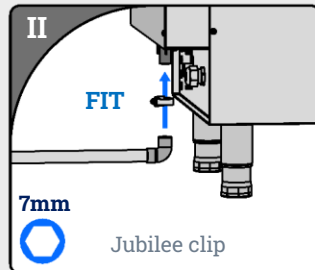
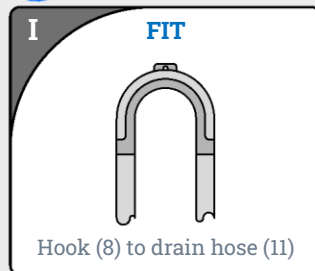

4 WATER SOFTENER UNIT (WS Models Only)

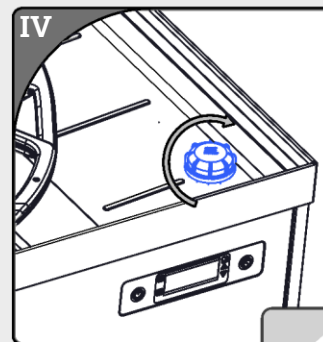
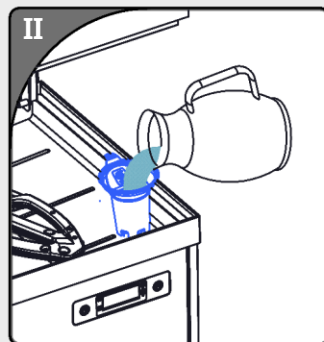
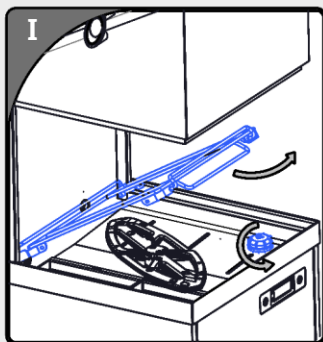

5 POSITIONING

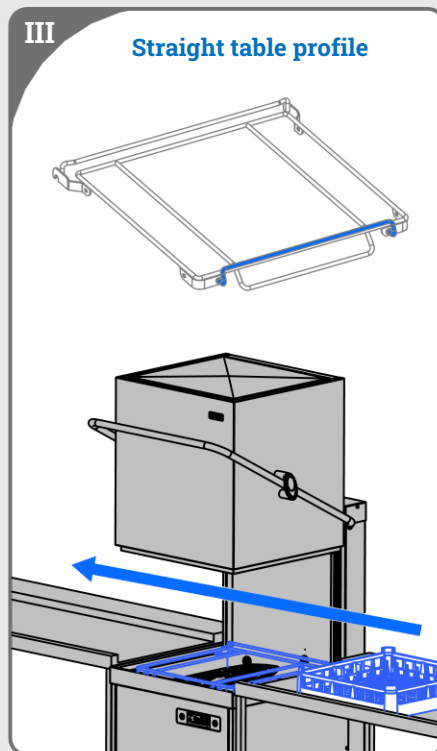
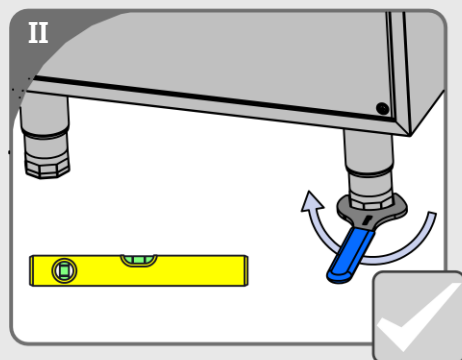
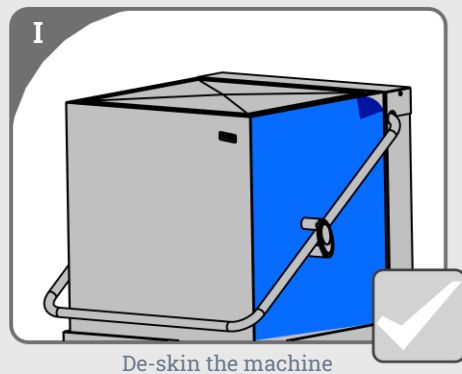

The basket ramp can be placed into its allotted slot

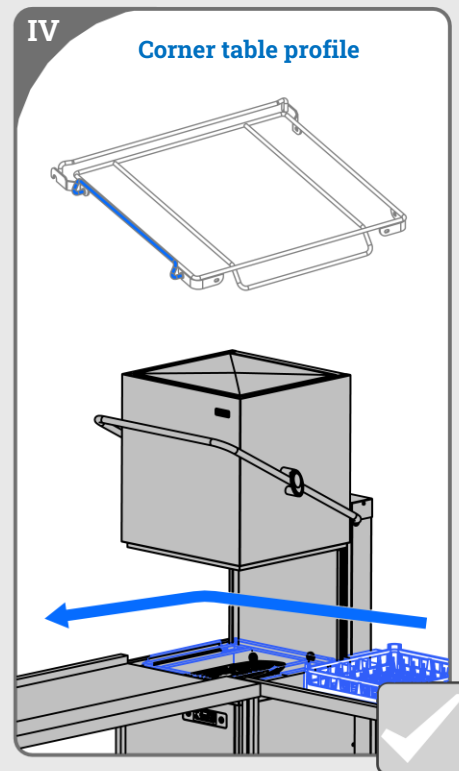

Move the front bar on the basket ramp to your required side

6 COMMISSIONING

1		<p>SET LANGUAGE > ENGLISH DEUTSCH</p>	<p>ENGLISH DEUTSCH ESPANOL NEDERLANDS POLSKIE PYCCKИЙ ITALIANO FRANCAIS CESTINA TURKEY ARABIC</p>	6		<p>EXTERNAL WATER TREATMENT CAPACITY</p>	<p>RANGE: 1 LITRE (MIN) 99999 LITRES (MAX)</p> <p><i>*Machine with external water softener ONLY*</i></p>
2		<p>INITIAL SETUP START?</p>		7		<p>SET DETERGENT 2.5mL/L</p>	<p>RANGE: 0.0 ml/ LITRE (MIN) 9.9 ml/ LITRE (MAX)</p>
3		<p>SET WASH MODE > GLASS DISH</p>	<p>GLASS: 60°C 70°C DISH: 60°C 82°C</p>	8		<p>SET RINSE AID 0.5mL/L</p>	<p>RANGE: 0.0 ml/ LITRE (MIN) 9.9 ml/ LITRE (MAX)</p>
4		<p>SOUND ALERTS > OFF ON</p>	<p>NOTIFICATIONS > CYCLE FINISH</p>	9		<p>CHEMICAL PRIMING START?</p>	<p>RUN TIME: APPROX 12 MINS</p>
5		<p>WATER HARDNESS 30°DH</p>	<p>RANGE: 01°DH [SOFT] (MIN) 30°DH [HARD] (MAX)</p> <p><i>*Machine with external water softener ONLY*</i></p>	10		<p>COMPLETE</p>	<p>ENJOY!</p>

STEAM RECOVERY UNIT (SR Models Only)

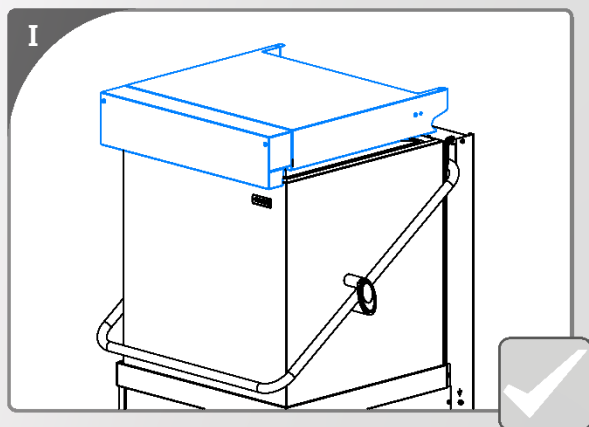

Lift the steam recovery unit into place



CAUTION

For safety, this activity requires 2 people.

Risk of trapping hands and fingers. **DO NOT** lift from the bottom. Ensure hands are clear from the connection point before lowering the steam unit.

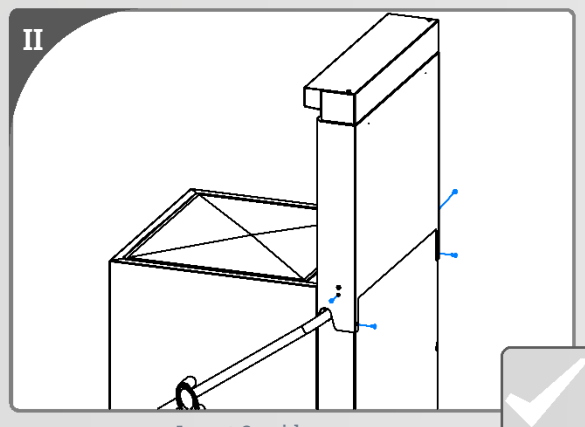
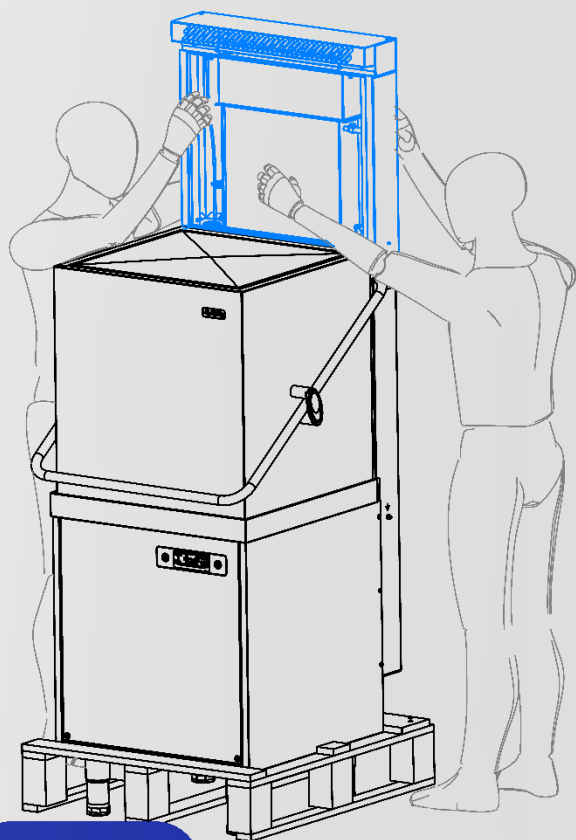

Insert 2x side screws
2x back screws

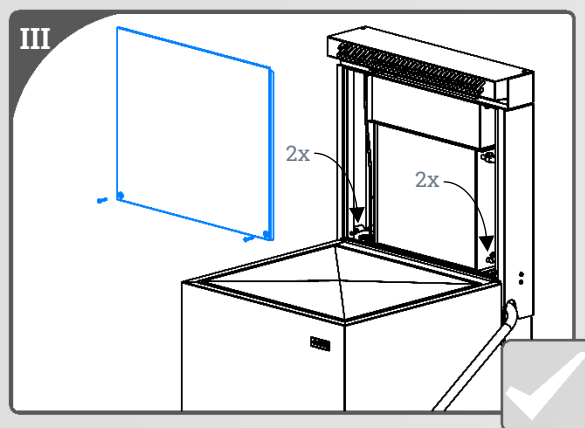

Insert 4x inside screws
Place the steam recovery front panel into its location

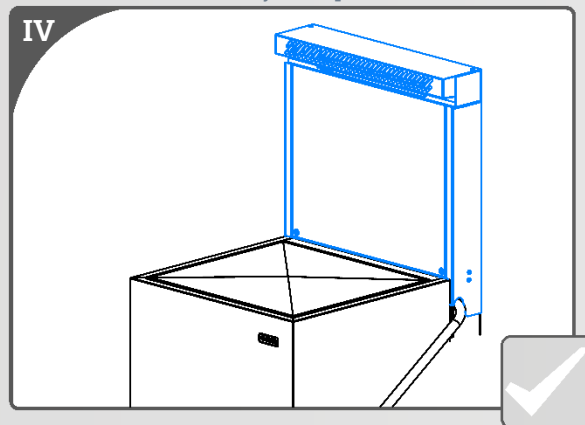

Insert 2x front screws

CLASSEQ



Visit our
APP here!

CLASSEQ



Simple, Robust